

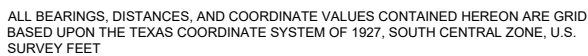

REDHAWK OPERATING, LLC

LAVACA COUNTY, TEXAS
UNIT/LEASE SURVEY

SHEET 1 OF 2



SCALE: 1" = 2000'



0' 1000' 2000'

GROUND ELEVATION: 320'

William Daniels

FILE NAME LO_BLACKSHEAR_UNIT_1H_REV2
A.V.F.

LEGEND

UNIT BOUNDARY

SURVEY/SECTION LINE

HIGHWAY

ROAD WAY

IRON PIPE FOUND

IRON ROD FOUND

SQUARE BOLT FOUND

FENCE POST/CORNER

#	MINERAL OWNER	ACREAGE
16	KEITH A. KUBENKA, ET UX	0.59
17	MK JANAK, LLC -LAVACA FIVE STAR SERIES	25.79
23	STEVE ROZNOVSKY, JR., ET AL	4.60
26	DENNIS M. SHIMEK, ET AL	38.48

LAVACA COUNTY, TEXAS

SHEET 2 OF 2

TARGET POINT
X=2637370.90
Y=626550.70
LAT.: N 29°32'29.56"
LONG.: W 96°59'43.34"

SURFACE LOCATION
X=2638425.15
Y=626369.86
LAT.: N 29°32'27.59"
LONG.: W 96°59'31.44"

FIRST TAKE POINT
X=2639187.79
Y=626223.51
LAT.: N 29°32'26.01"
LONG.: W 96°59'22.83"

PENETRATION POINT
X=2639227.57
Y=626216.34
LAT.: N 29°32'25.94"
LONG.: W 96°59'22.38"

KICK OFF POINT
X=2639537.55
Y=626160.52
LAT.: N 29°32'25.33"
LONG.: W 96°59'18.89"

LAST TAKE POINT/TERMINUS LOCATION
X=2629040.54
Y=630259.40
LAT.: N 29°33'07.68"
LONG.: W 97°01'16.93"

DETAIL VIEW A
SCALE: 1" = 400'

DETAIL VIEW B
SCALE: 1" = 300'

DETAIL VIEW C
SCALE: 1" = 400'

ALL BEARINGS, DISTANCES, AND COORDINATE VALUES CONTAINED HEREON ARE GRID
BASED UPON THE TEXAS COORDINATE SYSTEM OF 1927, SOUTH CENTRAL ZONE, U.S.
SURVEY FEET

ORIGINAL DOCUMENT SIZE: 8.5" X 14"

LEASE NAME & WELL NO.:BLACKSHEAR UNIT 1H

DATE OF SURVEY:OCTOBER 30, 2024

LOCATED:±7.3 MILES NORTHWEST OF HALLETTSVILLE, TX

GROUND ELEVATION:320'

FILE NAMELO_BLACKSHEAR_UNIT_1H_REV2
A.V.F.